

January 2022 DRAFT

For Discussion Purposes Only

§240-24.1.1 Downtown Hyannis Zoning Districts

§240-24.1.2 Title

These districts shall be collectively known as the "Downtown Hyannis Zoning Districts."

§240-24.1.3 General Provisions

A. Applicability

1. Where the provisions of this Section conflict with those found elsewhere in the Barnstable Zoning Ordinance, the provisions of this Section apply.
2. The provisions of the Barnstable Zoning Ordinance § 240-6.C(3) do not apply within the Downtown Hyannis Zoning Districts.

B. Development Review

1. The Planning Board is the Special Permit Granting Authority (SPGA) for all development within the Downtown Hyannis Zoning Districts.
2. Development within the Downtown Hyannis Zoning Districts, excluding single-family residences, must comply with Article IX, §240-103, site development standards, and the Design and Infrastructure Plan.
3. The use of land or occupancy of floor space is permitted as specified by §240-24.1.5.B Use Provisions.

C. Compliance

1. Any modification to an existing structure that results in greater conformance to this Ordinance is permitted.
2. Any modification to an existing structure that increases an existing nonconformity or creates a new nonconformity is prohibited.

January 2022 DRAFT

For Discussion Purposes Only

§240-24.1.4 Definitions

A. General

1. The following defined words, phrases, and terms are applicable for real property within the Downtown Hyannis Zoning Districts.

Accessory Parking	Motor vehicle parking spaces that are incidental but supportive of a principal building(s).
Building Component	A structural projection from the main massing or roof of a building that increases habitable square footage or enhances the usefulness of floor area.
Commercial Parking	A surface parking lot or structured parking facility providing short- or long-term parking service for a fee.
Commercial Service	The provision of various services, entertainment, or recreational opportunities to individuals, groups, or businesses including animal care, assembly & entertainment, banking & financial services, building & home repair, business support, day care & education, maintenance & repair of consumer goods, personal services, gyms & health clubs, and recreational services.
Cultural Services	The provision of social or cultural services to individuals or groups including membership based social organizations and the production, manufacture, publishing, rehearsal, performance, broadcast, selling, or teaching of the arts.
Development	The platting of any lot, construction of any structure, or establishment of any parking lot that did not exist prior to the adoption of the Downtown Hyannis Zoning Districts.
Façade.	Any exterior wall of a principal building oriented toward a front lot line.
Fenestration	The openings in the facade of a building, including windows and doors.
Food & Beverage Services	The provision of food or beverages for on- or off-site sale or consumption.
Forecourt	An open space between the forward projecting wings of a building.

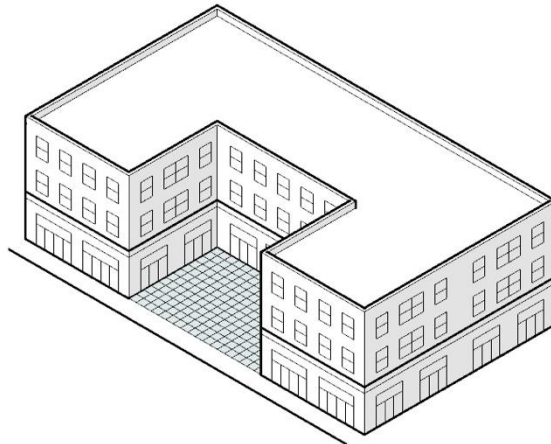

January 2022 DRAFT

For Discussion Purposes Only

Frontage Area	The area of a lot between the façade of a principal building and any front lot line(s), projected to the side lines of the lot.
Frontage Type	A distinct combination of façade and frontage area design features.
Health Care Clinic	The provision of health care services to patients or clients excluding in patient or overnight care.
Hospital	A facility for the care and treatment of patients as licensed by the Massachusetts Department of Public Health under MGL c. 111, §51.
Lot Coverage	The ratio or percentage of a lot that is covered by principal buildings, outbuildings, accessory structures, and impervious paved surfaces including driveways, parking lots and sidewalks.
Modification	The alteration or structural change of an existing structure and any change to the parking capacity of an existing parking lot.
Office	The administrative, professional, or clerical operations of a business and the provision of outpatient health services to patients or clients by appointment.
Outbuilding	A free-standing, fully enclosed structure for an accessory use or for activities customary to the principal use of land or a principal building.
Principal Building	The primary building on a lot.
Principal Entrance	The addressed entrance to a building or commercial space.
Recreational Facility	The provision of public recreational services including bowling and billiards, and video arcades.
Research & Development	The analysis, testing, and development of ideas and technology including computer software, information technology, communications systems, transportation, and multi-media technology where the construction of prototypes may be an ancillary activity.
Residential	The provision of living accommodations.
Retail Sales	The sale, lease, or rental of new or used goods to the ultimate consumer.
Shrub, Large	A multi-stemmed, woody plant with an expected mature height of six (6) feet.
Shrub, Medium	A multi-stemmed, woody plant with an expected mature height of four (4) feet.
Shrub, Small	A multi-stemmed, woody plant with an expected mature height of two (2) feet.
Story	The portion of a building located between the surface of a habitable floor and the surface of the habitable floor or roof next above.
Story, Ground	The lowest story of a building with a finished floor at or above the finished ground level next to a building at the facade.
Story, Upper	Any story above the ground story of a building.
Through Lot	A lot fronting on two (2) or more improved ways, excluding a corner lot.

January 2022 DRAFT

For Discussion Purposes Only

Tree, Canopy	A deciduous tree with an expected mature height of thirty (30) feet or more.
Tree, Evergreen	An evergreen tree (conifer) with an expected mature height of thirty (30) feet or more.
Tree, Understory	A deciduous tree with an expected mature height of less than thirty (30) feet.
Visitor Accommodations	The provision of temporary lodging in guest rooms or guest units for a fee.

DRAFT

January 2022 DRAFT

For Discussion Purposes Only

§240-24.1.5 Standards for all Districts

A. Building Standards

1. Frontage types.
 - (a) Buildings must have at least one (1) frontage type. Buildings on corner lots must have two (2) frontage types, one (1) for each frontage.
 - (b) Frontage types are permitted as specified by Table 11.
 - (c) Multiple frontage types may exist for buildings that have more than one (1) principal entrance.
2. Buildings must have at least one (1) principal entrance located on the façade.
 - (a) Multi-story buildings with ground floor commercial space(s) must have one (1) principal entrance for each commercial space in addition to any principal entrance(s) necessary for any upper stories.
3. Buildings may not exceed the maximum number of stories specified for each district.
 - (a) Each individual story of a building must comply with the minimum and maximum story height specified for each district.
 - (b) Story height is measured vertically from the surface of the finished floor to the surface of the finished floor above. When there is no floor above, story height is measured from the surface of the finished floor to the top of the structural beam or joists above or the top of the wall plate, whichever is more.
 - (c) The ground story is always counted as one (1) story, except that a single ground story over eighteen (18) feet in height is counted as two (2) stories.
 - (d) Each upper story is counted as one (1) additional story, except that any upper story over sixteen (16) feet is counted as two (2) stories.
 - (e) Basements are not counted as one (1) story unless the finished floor of the ground story is five (5) feet or more above the average ground level of the lot.
 - (f) Habitable space located directly under a pitched roof is counted as a half (0.5) story.
 - (i) The roof rafters of a half story must intersect the wall plate or top of wall frame of the exterior walls at a height no more than (2) feet above the finished floor of the half story.
 - (g) Non-habitable attic space located under a pitched roof is not counted a half story.
 - (h) Pitched roofs with a slope greater than 12:12 require a Special Permit.
4. Buildings may not exceed the maximum building height specified for each district, as applicable.
 - (a) Building height is measured as the vertical distance from the average finished ground level to the top of the structural beam or joists of the upper most story.
5. Non-habitable architectural features including, but not limited to, mechanical & stairwell penthouses; vents or exhausts; solar panels or skylights; belfries, chimneys, cupolas, parapets, spires, and steeples are not included in any building height calculations and are permitted on roofs.
6. Building components are permitted as specified by Table 12.
7. Facades must have fenestration as specified for each district, as applicable.
 - (a) Fenestration is calculated as a percentage of the area of a façade.
 - (b) For buildings with ground story commercial spaces, ground story fenestration is measured between two (2) feet and twelve (12) feet above the finished floor of the ground story.

January 2022 DRAFT

For Discussion Purposes Only

- (c) For all other buildings and all other building stories, fenestration is measured independently for each story, corresponding with the top of a finished floor to the top of the finished floor above.
- 8. Fenestration enclosed with glass may be included in the calculation if it meets the following criteria:
 - (a) For ground story fenestration, glazing must have a minimum sixty percent (60%) Visible Light Transmittance (VLT) and no more than fifteen percent (15%) Visible Light Reflectance (VLR) as indicated by the manufacturer.
 - (b) For upper story fenestration, glazing must have a minimum of forty percent (40%) VLT and no more than fifteen percent (15%) VLR as indicated by the manufacturer.

B. Use Provisions

1. General

- (a) The use of real property is permitted as specified by Table 1.
 - (i) Table 1 is organized by broad use categories and specific uses that may be regulated differently than other uses from the same category.
 - (ii) Use categories are intended to include uses with similar functional, product, or physical characteristics; the type and amount of activity; the manner of tenancy; the conduct of customers; how goods or services are sold or delivered; and the likely impacts on surrounding properties.
 - (iii) Where Table 1 identifies a category followed by “except as follows,” any use that meets the definition of that use category is permitted by right, while the specific uses identified in the list under that category are either not permitted, are permitted with limitations, or require a special permit despite belonging to the same use category.
 - (iv) Where Table 1 identifies a category followed by “as specified below,” the specific uses listed under the category are the only land uses permitted from that use category.
- (b) The Building Commissioner shall classify the actual use of land or structures using the defined use categories specified on Table 1. Also see §240-24.1.4 Definitions.
 - (i) Real property may have one (1) or more principal use(s).
 - (ii) Once classified into a use category, the use of land or structures in the same manner cannot also be classified into another use category.
 - (iii) The use of land or structures in a manner that is inconsistent with a permitted use category or specific use type specified on Table 1 is prohibited.
 - (iv) Unless classified as a specific use that is not permitted in a zoning district, an existing nonconforming use may be changed to another nonconforming use that is from the same use category as the existing nonconforming use by Special Permit.
 - (v) A nonconforming use may not change to a different nonconforming use that is from a different use category than the existing nonconforming use.

January 2022 DRAFT

For Discussion Purposes Only

Use Category Specific Use	DMS	DV	DN	HH	TC	HC	DH
Commercial Services (except as follows)	P	P	N	P	P	P	P
Automobile Maintenance & Repair	N	N	N	N	N	N	N
Boat Storage	N	N	N	N	N	N	N
Contractor Services	N	N	N	N	N	N	N
Funeral Services	N	N	N	N	N	N	N
Marina	N	N	N	SP	N	N	N
Commercial Parking	N	N	N	N	P	SP	N
Public Transportation Maintenance	N	N	N	N	SP	N	N
Recreational Facility	SP	SP	N	SP	SP	SP	SP
Self-Storage Facility	N	N	N	N	N	SP	N
Veterinary Services	N	N	N	N	N	P	N
Cultural Services (as specified below)	--	--	--	--	--	--	--
Arts & Culture Establishments	P	P	N	P	P	P	N
Fraternal & Social Organizations	P	P	N	P	P	P	N
Performing Arts & Theaters	P	P	N	P	P	P	N
Artist Live/Work	P	P	P	P	P	N	N
Food & Beverage Services (except as follows)	L	L	N	L	P	P	P
Brewery/Distillery	L	N	N	N	N	N	N
Hospital	N	N	N	N	N	N	P
Office (except as follows)	P	P	L	P	P	P	P
Health Care Clinic	P	P	L	P	N	P	P
Research & Development	P	P	N	P	N	P	P
Residential (as specified below)	--	--	--	--	--	--	--
Multi-Unit Dwelling	L	L	N	L	L	N	N
Two-Unit Dwelling	P	P	L	N	N	N	N
Single Unit Dwelling	N	P	P	N	N	N	N
Retail Sales (except as follows)	L	L	N	L	P	P	P
Boat Sales	N	N	N	SP	N	N	N
Gasoline Sales	N	N	N	N	N	N	N
Motor Vehicle Sales	N	N	N	N	N	N	N
Visitor Accommodations (as specified below)	--	--	--	--	--	--	--
Hotel/Motel	P	N	N	P	N	P	N
Bed & Breakfast	N	P	P	P	N	N	N

P – Permitted By-Right SP – Special Permit
 N – Not Permitted L – Permitted with Limitations (see district)

January 2022 DRAFT

For Discussion Purposes Only

C. Parking Standards

1. Applicability

- (a) Parking is required based on the intended use of floor area within a building at construction permitting and not for the subsequent establishment, change, or expansion of any permitted use; or the renovation of any existing principal building.

2. General

- (a) Accessory parking must be provided as specified by Table 2 and is calculated as the sum of all required spaces, including any adjustment specified for on-site shared parking.
 - (i) Commercial Parking uses are exempt from Table 2.
- (b) Relief from the parking requirements of Table 2 requires a Special Permit.
- (c) In its discretion to approve or deny a Special Permit authorizing relief from the minimum parking requirements of Table 2, the Planning Board shall consider conditioning the Special Permit upon one or more of the following:
 - (i) Elimination or reduction of existing curb cuts and driveway aprons
 - (ii) Establishment of a shared driveway or cross-access connection between abutting parking lots with a binding easement and joint maintenance agreement defining the responsibilities of abutting property owners sharing access.

3. Location

- (a) Accessory parking spaces must be located on the same lot as the building they support and may be provided within a principal building or outbuilding or as surface parking.
- (b) Motor vehicle parking of any type is prohibited within the frontage area of a lot and any required landscape buffer.
 - (i) Real property in the Highway Commercial (HC) district is exempt.

January 2022 DRAFT

For Discussion Purposes Only

Table 2. Minimum Required Accessory Parking Spaces

Use Category	DMS	DV	DN	DH	HH	TC	HC	On Site Shared Parking Adjustment ¹
Commercial Services (per 1,000 sf)	0	4	N/A	4	4	4	4	Subtract 80% of any spaces provided for any Residential uses on the same lot from the total required for all uses
Cultural Services (per 1,000 sf)	0	4	4	4	N/A	4	4	Subtract 20% of any spaces provided for any Residential uses on the same lot from the total required for all uses
Food & Beverage Services (per 1,000 sf)	0	4	N/A	4	4	4	4	--
Hospital (per 3 beds)	N/A	N/A	N/A	1	N/A	N/A	N/A	--
Office (per 1,000 sf)	3	3	3	3	3	3	3	Subtract 80% of any spaces provided for any Residential uses on the same lot from the total required for all uses
Residential or Artist Live/Work (per DU)	1	1	1	N/A	1	1	N/A	--
Retail Sales (per 1,000 sf)	0	4	N/A	4	4	4	4	Subtract 20% of any spaces provided for any Residential uses on the same lot from the total required for all uses
Visitor Accommodations (per room)	1.25	1.25	1.25	N/A	1.25	N/A	1.25	--

¹ Rounded up to the nearest whole number

January 2022 DRAFT

For Discussion Purposes Only

D. Site Standards

1. Forecourts

- (a) Driveways and passenger drop-offs are permitted in forecourts by Special Permit.
 - (ii) Real property fronting Main Street or in the Downton Hospital (DH) district is exempt.
- (b) Garage entrances, parking spaces, loading and service areas, exhaust vents, mechanical equipment, and refuse or recycling storage are not permitted in forecourts.

2. Landscaping

- (a) Lot area uncovered by structures or impermeable surfaces must be landscaped.
- (b) New canopy trees must be at least fourteen (14) feet in height or three (3) inches in caliper when planted.
- (c) New understory trees must be at least ten (10) feet in height or one and a half (1.5) inches in caliper when planted.
- (d) New evergreen trees must be at least eight (8) feet in height when planted.
- (e) Vegetation must be low water use and low maintenance plant species that are indigenous to Cape Cod. Plant species should be capable of withstanding seasonably wet conditions and provide habitat value for wildlife.
- (f) Landscaped areas must be maintained, irrigated, and fertilized. Vegetation should be organically maintained to every extent practicable.
- (g) Vegetation may not obscure any driveways, vehicular entrances, or roadway intersections.
- (h) Mulch may not be placed in a manner that will wash into catch basins or drainage pipes.
- (i) All Site Plan and Special Permit applications must submit a Landscape Plan(s) signed and stamped by a MA registered Landscape Architect unless waived/exempt by the Building Commissioner.
- (j) The Building Commissioner shall not issue a Certificate of Occupancy until the landscaping has been installed in accordance with the approved plans unless the property owner posts security to the Town of Barnstable for one hundred and fifty percent (150%) of the estimated cost of installation of the landscaping.
- (k) Any fractional value required for plant materials is rounded up to the next whole number.

3. Stormwater Management

- (a) Rain gardens should be used to the maximum extent practicable. Rain gardens are defined as landscaped areas designed to absorb and filter stormwater runoff from impervious surfaces.

4. Signs

- (a) All development shall comply with the applicable signage requirements contained in Article VII, Sign Regulations, at §240-59 through 240-89, inclusive, of the Barnstable Zoning Ordinance. Internally illuminated signs are prohibited in the Downtown Hyannis Zoning Districts.

January 2022 DRAFT

For Discussion Purposes Only

5. Outdoor Lighting

- (a) All outdoor lighting must be directed only on site.
 - (i) The trespass of light at any lot line may not exceed 0.1 of a footcandle, except that the trespass of light at any lot line abutting a lot in Downtown Neighborhood (DN) district may not exceed 0.05 footcandle.
 - (ii) At driveways, lighting may be up to 0.5 of a footcandle at the front lot line.
 - (iii) Outdoor lighting may not cause glare that impacts motorists, pedestrians, or neighboring premises.
- (b) Light fixtures must have a total cutoff of all light at less than ninety degrees (90°) and a beam cutoff of less than seventy-five degrees (75°). Attached building or wall pack lighting should be screened by the building's architectural features or contain a forty-five-degree cutoff shield.
- (c) Electrical service for lighting on posts or poles must be located underground.

6. Fences

- (a) Fences greater than four (4) feet in height in the frontage area and seven (7) feet in height in all other locations at any point along their length require a Special Permit.
- (b) Fences may be no more than fifty percent (50%) open.
- (c) Fence posts and supporting rails must face inward toward the property being fenced and the finished face must be oriented towards the abutting lot.

7. Vehicular Access

- (a) Driveways, vehicular entrances to parking lots or structures, and curb cuts must comply with the minimum or maximum width specified for each district.
- (b) Driveways are not permitted in the frontage area of a lot between a principal building and the front lot line, but may be set to the side and traverse the frontage area.
- (c) Drive throughs require a Special Permit and are only permitted for the following uses:
 - (i) Banks (a specific use of the Commercial Service use category)
 - (ii) Pharmacies (a specific use of the Retail Sales use category)
- (d) All new curb cuts require a Special Permit.
- (e) The interior width of a curb cut (between the curb stones or flares) may be no wider than the driveway, vehicular entrance, or loading facility it serves.
- (f) A driveway apron may be installed within a sidewalk of an improved way, but the grade, cross slope, and clear width of the pedestrian walkway must be maintained between the driveway apron and the abutting driveway.
- (g) The appearance of the pedestrian walkway (ie. scoring pattern or paving material) must indicate that, although a vehicle may cross to enter a property, the area traversed by a vehicle remains part of the sidewalk.

8. Utilities

- (a) All mechanical equipment must be screened from view from adjacent lots and public rights-of-way and integrated into or compatible with the architectural design of the building.

January 2022 DRAFT

For Discussion Purposes Only

E. Surface Parking Lot Design Standards

1. Applicability

- (a) This section is applicable to the construction of any new surface parking lot and the expansion or modification of an existing surface parking lot that increases the number of parking spaces by five (5) or more.

2. General

- (a) To reduce traffic congestion and increasing convenience for customers, employees, and residents, development is encouraged to provide direct vehicular connections between abutting parking lots so that motor vehicles can move between properties without re-entering the public street.
- (b) To increase walkability and reduce conflicts between pedestrians and motor vehicles, development is encouraged to provide access to rear parking lots via driveways that are shared between abutting properties or multiple properties on the same block face.

3. Surface Parking Lot Landscaping

- (a) One (1) three (3) inch minimum caliper low-water-use, low-maintenance tree must be provided for every five (5) parking spaces and must be located within ten (10) feet of the parking lot. Trees shall be maintained and irrigated as necessary and planted within at least fifty (50) square feet of permeable area. Existing trees located in the interior of parking lots are credited toward this requirement.
- (b) A front landscaped buffer at least ten (10) feet wide must be provided between any parking lot and any lot line abutting an improved way and must include the following features over the span of fifty (50) linear feet:
 - (i) Two (2) canopy trees
 - (ii) One (1) understory or evergreen tree
 - (iii) Five (5) medium shrubs and five (5) small shrubs or a fence or wall a maximum of four (4) feet in height.
- (c) A side/rear landscaped buffer at least six (6) feet wide must be provided between any side or rear lot line and any parking lot with five (5) or more parking spaces, excluding any vehicular connections to abutting parking lots and must include the following features over the span of fifty (50) linear feet:
 - (i) Two (2) canopy trees
 - (ii) One (1) understory or evergreen tree
 - (iii) Five (5) medium shrubs and five (5) small shrubs or a fence or wall at least six (6) feet in height.
- (d) A landscaped buffer at least ten (10) feet wide must be provided between any building and any parking lot with ten (10) or more parking spaces, excluding building entrances, service and loading areas, and utility locations, and must include the following features over the span of fifty (50) linear feet:
 - (i) One (1) canopy tree
 - (ii) Two (2) understory or evergreen trees
 - (iii) Four (4) medium shrubs
 - (iv) Six (6) small shrubs
- (e) At least ten percent (10%) of any parking lot with ten (10) or more parking spaces must be landscaped. Lot area required as a landscape buffer is excluded from the calculation of the parking lot area.

January 2022 DRAFT

For Discussion Purposes Only

- (f) Landscape islands abutting a single row of parking spaces must be at least six (6) feet in width and the same length as the parking spaces. Each island must include one (1) three (3) inch minimum caliper, low-water-use, low-maintenance tree.
- (g) Landscape islands abutting a double row of parking spaces must be at least eight (8) feet in width and the same length as the parking spaces. Each island must include two (2) three (3) inch minimum caliper, low-water-use, low-maintenance trees.

DRAFT

January 2022 DRAFT

For Discussion Purposes Only

§240-24.1.6 Downtown Main Street District (DMS)

A. Intent

1. The Downtown Main Street District is intended to promote the continuation of a walkable, pedestrian-oriented downtown environment with continuous active streetscape. Development is characterized by mid-rise mixed-use buildings, continuous street walls and variety of materials with parking visually minimized. Land uses are mixed residential and active commercial, including retail, restaurant, office, hospitality, cultural and institutional.

B. Lot Standards

1. Newly platted lots must be dimensioned as specified by Table 3.
2. Building facades must have a minimum width that is equal to a percentage of a lot's width and is specified as the façade build out by Table 3.
 - (a) Façade build out is calculated by dividing the total width of all facades by the lot width and may be cumulatively calculated by multiple buildings.
 - (b) The open space of a forecourt is considered part of the building for the purpose of measuring building width and façade build out.

Façade Build Out

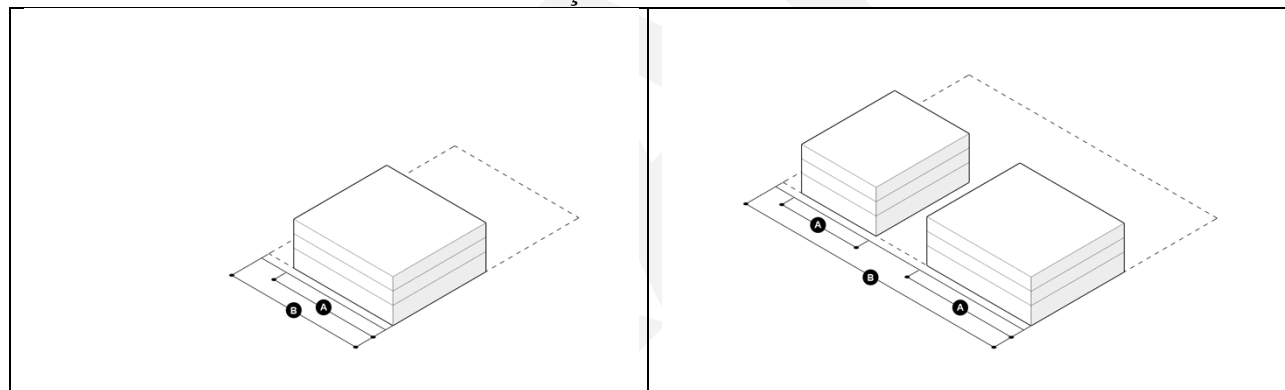

Single Building per Lot = $A \div B$

Multiple Buildings per Lot = $(A+A) \div B$

C. Building Standards

1. Multiple principal buildings are permitted per lot.
2. Principal buildings are permitted as specified by Table 3.
 - (a) Additional principal buildings are exempt from the required maximum front setback upon satisfaction of the façade built out requirement for the lot by other buildings.
3. Principal building façade(s) must be built parallel to any primary front lot line, at or between the minimum and maximum front setbacks.
4. Any building contributing toward the frontage buildout for any lot fronting Main Street between Ocean Street and Sea Street must provide ground story commercial space that is at least twenty (20) feet in depth for one hundred percent (100%) of the total width of the building, excluding lobby entrances and other means of egress associated with the use of upper stories.
5. Awnings, canopies, signs, balconies, and non-habitable architectural features of a building may project over the public sidewalk but must provide at least eight (8) feet of

January 2022 DRAFT

For Discussion Purposes Only

clearance and a license from the Town Manager in accordance with Barnstable General Ordinances, Part 1, Chapter 121, § 121-6J is required.

6. The fourth (4th) story of any building must be recessed (“stepped back”) from the façade of the stories below at least eight (8) feet.

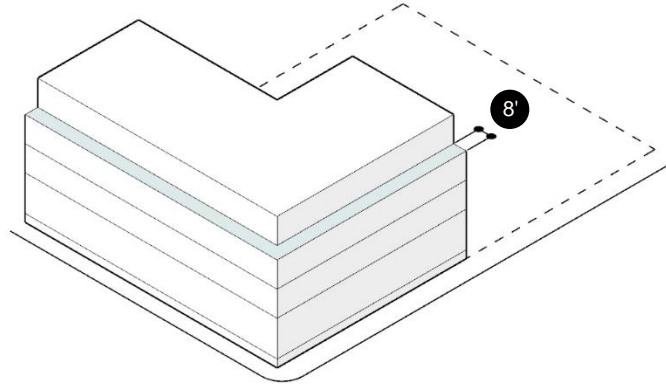

7. Mechanical & stairwell penthouses and building systems equipment must be setback from any exterior wall a distance that is equal to their height.
8. Facades may not have any blank wall areas without fenestration or architectural surface relief greater than twenty (20) feet measured both vertically and horizontally for all stories of a building for any facade.
9. Loading and service areas may not be visible from any public sidewalk of Main Street.

D. Design Guidelines

1. The development of any new principal building should include a pedestrian passage connecting the sidewalk at the front of the property to any parking areas to the rear of the building, to every extent practicable, where no such pedestrian passage exists within two hundred (200) linear feet of the building's principal entrance.

January 2022 DRAFT
For Discussion Purposes Only

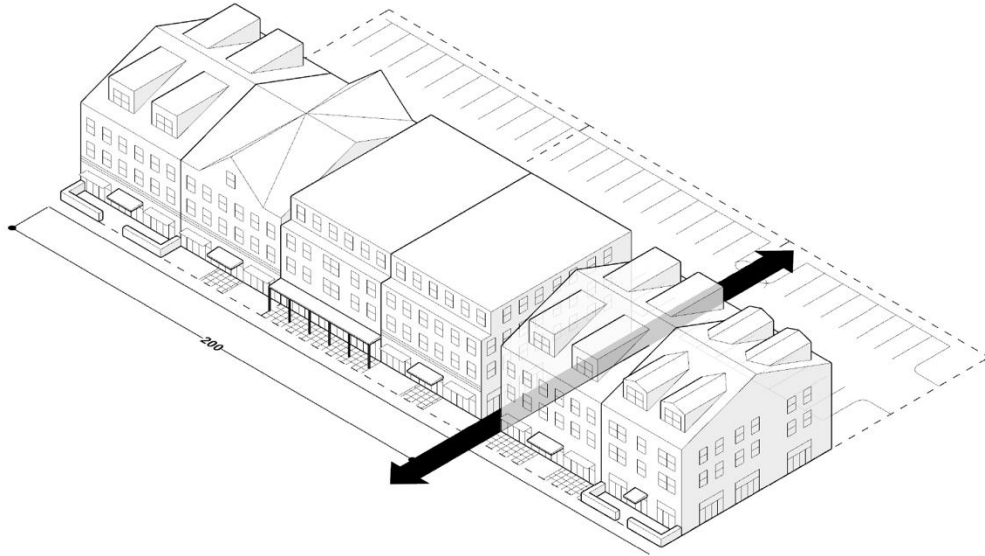

2. When provided, pedestrian passages may be designed as an open-air passage between buildings, a covered atrium providing continuous protection from the elements, or as an up to two (2) story passage through a building.

E. Use Provisions

1. Limitations

- (a) Occupation of a single commercial space greater than five thousand (5,000) square feet by any Food & Beverage Service or Retail Sales use requires a Special Permit.
- (b) The maximum number of dwelling units permitted for any Multi-Unit Dwelling residential use is determined by the permitted dimensions of the building and the actual motor-vehicle parking spaces provided on a lot as required by Table 2.

F. Site Standards

1. Driveways, vehicular entrances to parking lots or structures, and curb cuts may be no wider than twenty-four (24) feet.

G. Landscape Standards

1. A front landscape area is not required if the front setback is zero. When a setback is greater than zero, those portions of the setback not occupied by pedestrian amenities and public spaces shall be landscaped including one (1) canopy tree to be planted every thirty (30) feet of frontage of the property.
2. A side or rear landscaped area at least six (6) feet wide must be provided along any side or rear lot line abutting a lot in Downtown Neighborhood (DN) district and must include the following features over the span of fifty (50) linear feet:
 - (i) Two (2) canopy trees
 - (ii) One (1) understory or evergreen tree

January 2022 DRAFT

For Discussion Purposes Only

- (iii) Five (5) medium shrubs and five (5) small shrubs or a fence or wall at least six (6) feet in height.

H. Parking Standards

1. For development on any through lot fronting Main Street, parking access must be provided from the non-Main Street frontage.

DRAFT

January 2022 DRAFT

For Discussion Purposes Only

Table 3. DMS Dimensional Standards

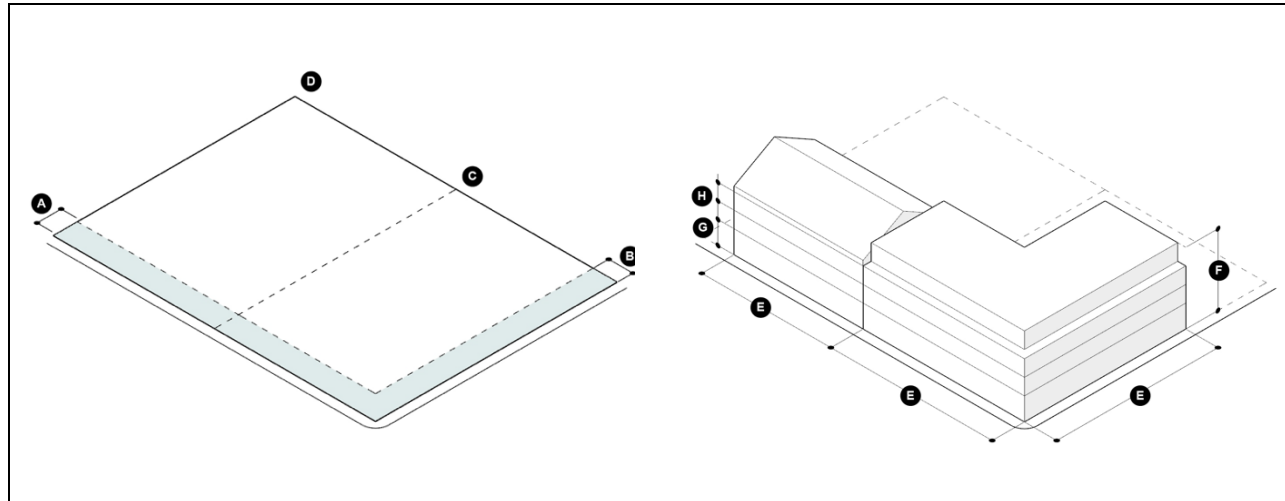

LOT		BUILDING FORM	
Lot Width	30' min	E - Building Width	180' max
Lot Coverage	100% max	F - Number of Stories	3.5 or 4 max ²
Façade Build Out (min)	--	G - Ground Story Height	--
Primary Frontage	80% min	Commercial	14' min
Secondary Frontage	40% min	Residential	10' min
SETBACKS – PRINCIPAL BUILDINGS		H - Upper Story Height	10' min
A - Primary Front Setback	0' min 15' max	BUILDING FEATURES	
B - Secondary Front Setback	0' min 15' max	Ground Story Fenestration	--
C - Side Setback	0' min	Primary Frontage	60% min
D - Rear Setback	0' min	Secondary Frontage	15% min
		Upper Story Fenestration	15% min
		Blank Wall	20' max
		Commercial Space Depth	20' min

² See 240-24.1.6.C.6 (4th Story Step-back)

January 2022 DRAFT

For Discussion Purposes Only

§240-24.1.7 Downtown Village District (DV)

A. Intent

1. The Downtown Village District is intended to promote mixed land uses that support the downtown core and reestablish or preserve traditional neighborhood forms and pedestrian orientation. Development is characterized by mid-rise single-use buildings and detached and semi-detached residential buildings.

B. Lot Standards

1. Newly platted lots must be dimensioned as specified by Table 4.
2. Lot coverage may not exceed the maximum specified by Table 4.
3. Building facades must have a minimum width that is equal to a percentage of a lot's width and is specified as the façade build out by Table 4.
 - (a) Façade build out is calculated by dividing the total width of all facades by the lot width and may be cumulatively calculated by multiple buildings.
 - (b) The open space of a forecourt is considered part of the building for the purpose of measuring building width and façade build out.

Façade Build Out

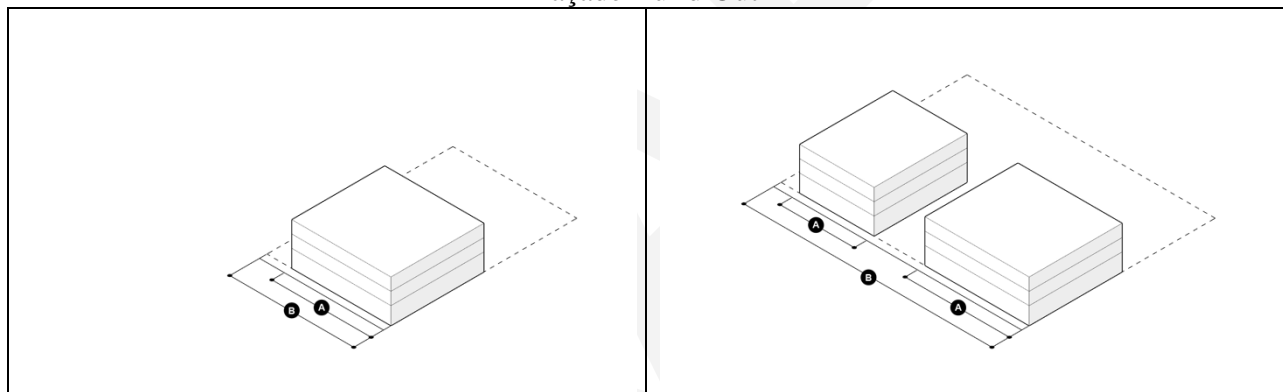

Single Building per Lot = $A \div B$

Multiple Buildings per Lot = $(A+A) \div B$

C. Building Standards

1. Multiple principal buildings are permitted per lot.
2. Principal buildings are permitted as specified by Table 4.
 - (a) Additional principal buildings are exempt from the required maximum front setback upon satisfaction of the façade built out requirement for the lot by other buildings.
3. Principal building façade(s) must be built parallel to any primary front lot line, at or between the minimum and maximum front setbacks.
4. The fourth (4th) story of any building must be recessed (“stepped back”) from the façade of the stories below at least eight (8) feet.
5. Mechanical & stairwell penthouses and building systems equipment must be setback from any exterior wall a distance that is equal to their height.

D. Use Provisions

1. Limitations

- (a) Occupation of a single commercial space greater than five thousand (5,000) square feet by any Food & Beverage Service or Retail Sales use requires a Special Permit.

January 2022 DRAFT

For Discussion Purposes Only

(b) The maximum number of dwelling units permitted for any Multi-Unit Dwelling residential use is determined by the permitted dimensions of the building and the actual motor-vehicle parking spaces provided on a lot as required by Table 2.

E. Site Standards

1. Driveways, vehicular entrances to parking lots or structures, and curb cuts may be no wider than twenty-four (24) feet.

F. Landscape Standards

1. A front landscape area is not required if the front setback is zero. When a setback is greater than zero, those portions of the setback not occupied by pedestrian amenities and public spaces shall be landscaped including one (1) canopy tree to be planted every thirty (30) feet of frontage of the property.

DRAFT

January 2022 DRAFT

For Discussion Purposes Only

Table 4. DV Dimensional Standards

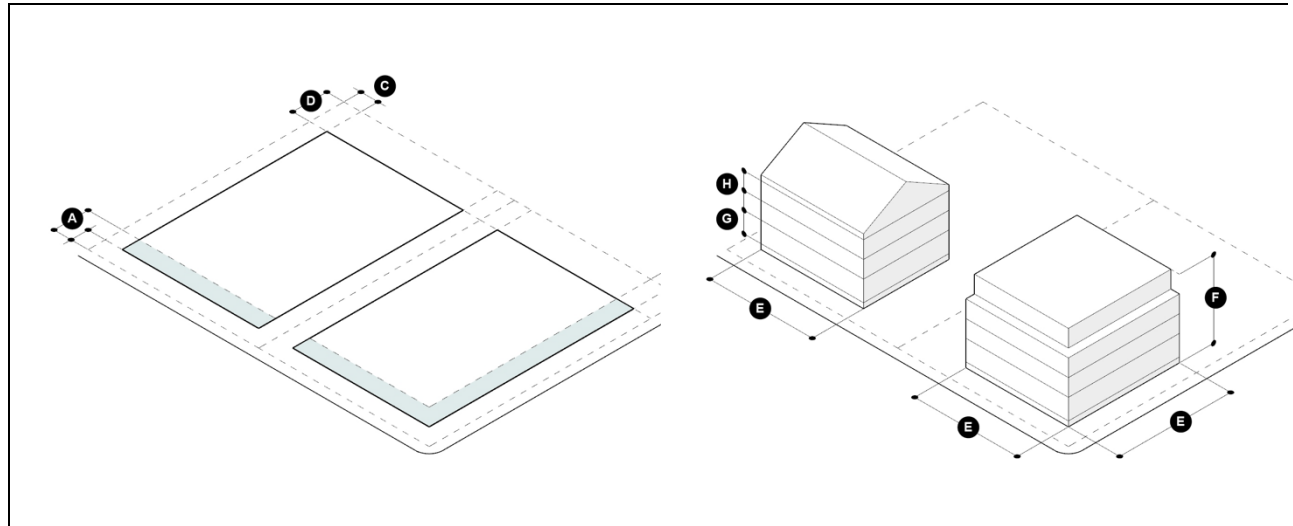

LOT		BUILDING FORM	
Lot Width	30' min	E - Building Width	120' max
Lot Coverage	80% max	F - Number of Stories	3.5 or 4 max ³
Façade Build Out (min)	--	G - Ground Story Height	--
Primary Frontage	80% min	Commercial	14' min
		Residential	10' min
SETBACKS – PRINCIPAL BUILDINGS		H - Upper Story Height	10' min
A - Primary Front Setback	0' min 15' max	BUILDING FEATURES	
B - Secondary Front Setback	0' min 15' max	Ground Story Fenestration	--
C - Side Setback	0' min	Primary Frontage	15% min
D - Rear Setback	0' min	Secondary Frontage	15% min
		Upper Story Fenestration	15% min
		Blank Wall	20' max
		Commercial Space Depth	20' min

³ See 240-24.1.6.C.6 (4th Story Step-back)

January 2022 DRAFT
For Discussion Purposes Only

§240-24.1.8 Downtown Neighborhood District (DN)

A. Intent

1. The Downtown Neighborhood District is intended to promote the traditional uses and form of the neighborhoods adjacent to downtown that are characterized by a variety of 19th and 20th Century detached and semi-detached residential building types.

B. Lot Standards

1. Newly platted lots must be dimensioned as specified by Table 5.
2. Lot coverage may not exceed the maximum specified by Table 5.

C. Building Standards

1. One (1) principal building and multiple outbuildings are permitted per lot.
2. Principal buildings and outbuildings are permitted as specified by Table 5.
 - (a) The third story in a single-family or two-family dwelling can only occur within habitable attic space.

D. Use Provisions

1. Limitations
 - (b) Office and Health Care Clinic uses are permitted only for lots fronting South Street or High School Road.
 - (c) Two-Unit dwellings are prohibited for lots fronting only Brookshire Road or King's Way.

E. Site Development

1. Development on corner lots must comply with the provisions of § 240-41 of the Barnstable Zoning Ordinance.
2. Curb cuts may be no wider than twelve (12) feet.
3. Outdoor lighting must be shielded and provide total cut off of all light at the boundaries of the lot under development.
4. Fences greater than four (4) feet in height in the frontage area and seven (7) feet in height in all other locations at any point along their length require a Special Permit.

F. Landscape Standards

- (i) A perimeter green space of not less than ten (10) feet in width shall be provided, such space to be planted and maintained as green area and to be broken only in a front yard by a driveway.

January 2022 DRAFT

For Discussion Purposes Only

Table 5. DN Dimensional Standards

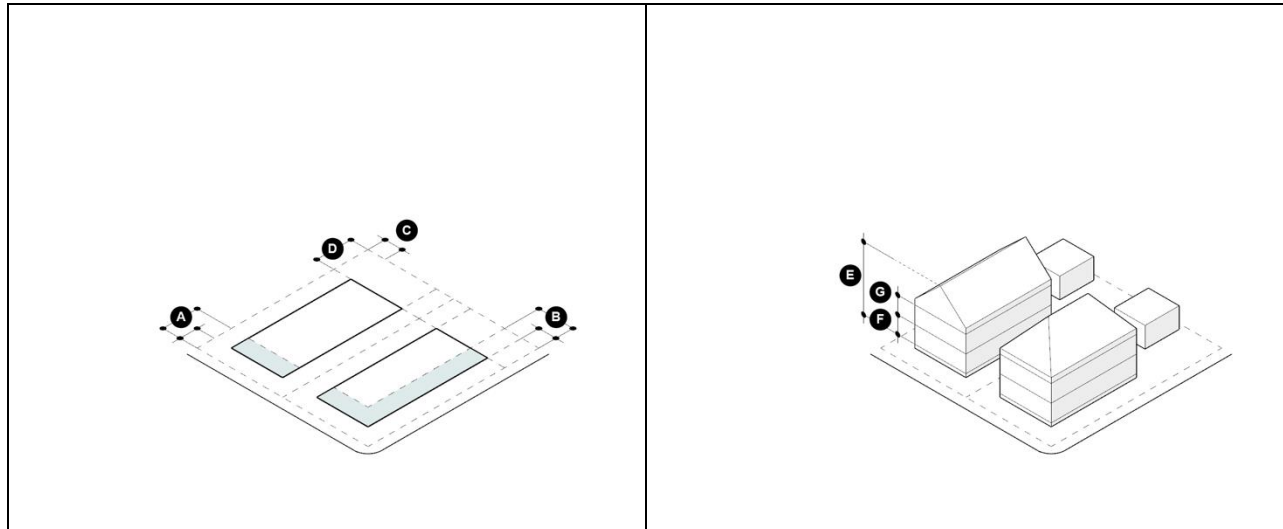

LOT		BUILDING FORM	
Lot Width	20' min	E - Number of Stories	3 max ⁴
Lot Coverage	50% max	F - Ground Story Height	10' min
SETBACKS – PRINCIPAL BUILDINGS		G - Upper Story Height	10' min
A - Primary Front Setback	10' min 20' max		
B - Secondary Front Setback	10' min 20' max		
C - Side Setback	10' min		
D - Rear Setback	20' min		
SETBACKS - OUTBUILDINGS			
Front Setback	60' min		
Side Setback	3' min		
Rear Setback	3' min		

⁴ See 240-24.1.8.C.2(a)

January 2022 DRAFT
For Discussion Purposes Only

§240-24.1.9 Downtown Hospital District (DH)

A. Intent

1. The Downtown Hospital District is intended to maintain an area of Hyannis for a large-scale Health Care Services institution and is characterized by moderate to large floor plate, multi-story buildings arranged in a campus-like setting, with clear pedestrian and vehicular connections to downtown and the region.

B. Lot Standards

1. Newly platted lots must be dimensioned as specified by Table 6.
2. Lot coverage may not exceed the maximum specified by Table 6.

C. Building Standards

1. Multiple principal buildings are permitted per lot.
2. Principal buildings are permitted as specified by Table 6.
3. Mechanical & stairwell penthouses and building systems equipment must be setback from any exterior wall a distance that is equal to their height.

D. Site Standards

1. Driveways, vehicular entrances to parking lots or structures, and curb cuts may be no wider than twenty-four (24) feet.

E. Landscape Standards

1. A front landscaped area at least ten (10) feet wide measured from the lot line toward the interior of the lot must include the following features over the span of fifty (50) linear feet:
 - (i) One (1) canopy tree
 - (ii) Two (2) understory or evergreen trees
 - (iii) Four (4) medium shrubs
 - (iv) Six (6) small shrubs

January 2022 DRAFT

For Discussion Purposes Only

Table 6. DH Dimensional Standards

LOT		BUILDING FORM	
Lot Width	50' min	Number of Stories	6 max
Lot Coverage	80% max	Building Height	85' max
SETBACKS – PRINCIPAL BUILDINGS			
Primary Front Setback	20' min		
Secondary Front Setback	20' min		
Side Setback	10' min		
Rear Setback	10' min		

January 2022 DRAFT
For Discussion Purposes Only

§240-24.1.10 Hyannis Harbor District (HH)

A. Intent

1. The Hyannis Harbor District is intended to maintain an area near Hyannis Inner Harbor for maritime activities and water-related uses, and is characterized by a mix of commercial, maritime industrial, and residential development and the presence of the commercial ferry services.

B. Lot Standards

1. Newly platted lots must be dimensioned as specified by Table 7.
2. Lot coverage may not exceed the maximum specified by Table 7.

C. Building Standards

1. Multiple principal buildings are permitted per lot.
2. Principal buildings are permitted as specified by Table 7.
 - (a) To support water-dependent uses on the harbor, the maximum building height permitted for existing structures used as a Marina or a Commercial Service use for constructing, selling, renting, or repairing boats is forty-five (45) feet.
3. Mechanical & stairwell penthouses and building systems equipment must be setback from any exterior wall a distance that is equal to their height.

D. Use Provisions

1. Limitations
 - (a) The maximum number of dwelling units permitted for any Multi-Unit Dwelling residential use is determined by the permitted dimensions of the building and the actual motor-vehicle parking spaces provided on a lot as required by Table 2.

E. Site Standards

1. Driveways, vehicular entrances to parking lots or structures, and curb cuts may be no wider than twenty-four (24) feet.

F. Landscape Standards

1. A front landscaped area at least ten (10) feet wide measured from the lot line toward the interior of the lot must include the following features over the span of fifty (50) linear feet:
 - (i) One (1) canopy tree
 - (ii) Two (2) understory or evergreen trees
 - (iii) Four (4) medium shrubs
 - (iv) Six (6) small shrubs
2. A side or rear landscaped area at least six (6) feet wide must be provided along any side or rear lot line abutting a lot in Downtown Neighborhood (DN) district and must include the following features over the span of fifty (50) linear feet:
 - (i) Two (2) canopy trees
 - (ii) One (1) understory or evergreen tree
 - (iii) Five (5) medium shrubs and five (5) small shrubs or a fence or wall at least six (6) feet in height.

January 2022 DRAFT
For Discussion Purposes Only

Table 7. HH Dimensional Standards

LOT		BUILDING FORM	
Lot Width	20' min	Number of Stories	2.5 max
Lot Coverage	90% max	Building Height	35 ft max ⁵
SETBACKS – PRINCIPAL BUILDINGS			
Primary Front Setback	20' min		
Secondary Front Setback	20' min		
Side Setback	10' min		
Rear Setback	10' min		

⁵ See 240-24.1.10.C.2(a)

January 2022 DRAFT

For Discussion Purposes Only

§240-24.1.11 Transportation Center District (TC)

A. Intent

1. The Transportation District is intended to accommodate transportation related-uses serving the downtown, harbor and the region and is characterized by functional buildings and parking areas screened and not highly visible from surrounding roadways.

B. Lot Standards

1. Newly platted lots must be dimensioned as specified by Table 8.
2. Lot coverage may not exceed the maximum specified by Table 8.

C. Building Standards

1. Multiple principal buildings are permitted per lot.
2. Principal buildings are permitted as specified by Table 8.
3. Mechanical & stairwell penthouses and building systems equipment must be setback from any exterior wall a distance that is equal to their height.

D. Use Provisions

1. Limitations

- (a) Occupation of a single commercial space greater than five thousand (5,000) square feet by any Food & Beverage Service or Retail Sales use requires a Special Permit.
- (b) The maximum number of dwelling units permitted for any Multi-Unit Dwelling residential use is determined by the permitted dimensions of the building and the actual motor-vehicle parking spaces provided on a lot as required by Table 2.

E. Site Standards

1. Driveways, vehicular entrances to parking lots or structures, and curb cuts may be no wider than twenty-four (24) feet.

F. Landscape Standards

1. A front landscaped area at least ten (10) feet wide measured from the lot line toward the interior of the lot must include the following features over the span of fifty (50) linear feet:
 - (i) One (1) canopy tree
 - (ii) Two (2) understory or evergreen trees
 - (iii) Four (4) medium shrubs
 - (iv) Six (6) small shrubs
2. A side or rear landscaped area at least six (6) feet wide must be provided along any side or rear lot line abutting a lot in Downtown Neighborhood (DN) district and must include the following features over the span of fifty (50) linear feet:
 - (i) Two (2) canopy trees
 - (ii) One (1) understory or evergreen tree
 - (iii) Five (5) medium shrubs and five (5) small shrubs or a fence or wall at least six (6) feet in height.

January 2022 DRAFT

For Discussion Purposes Only

Table 8. TC Dimensional Standards

LOT		BUILDING FORM	
Lot Width	50' min	Number of Stories	3 max
Lot Coverage	65% max	Building Height	40 ft max
SETBACKS – PRINCIPAL BUILDINGS			
Primary Front Setback	--		
Lots fronting Route 28	50' min		
All other Lots	20' min		
Secondary Front Setback	20' min		
Side Setback	10' min		
Rear Setback	10' min		

January 2022 DRAFT

For Discussion Purposes Only

§240-24.1.12 Highway Commercial District (HC)

A. Intent

1. The Highway Commercial District is intended to maintain an area for larger-scale commercial land uses, with private parking appropriately screened, on a regional roadway and promote in the long-term transformation of the area into a cohesive gateway corridor into Hyannis. The area is characterized by detached low- and mid-rise commercial structures.

B. Lot Standards

1. Newly platted lots must be dimensioned as specified by Table 9.
2. Lot coverage may not exceed the maximum specified by Table 9.

C. Building Standards

1. Multiple principal buildings are permitted per lot.
2. Principal buildings are permitted as specified by Table 9.
3. Mechanical & stairwell penthouses and building systems equipment must be setback from any exterior wall a distance that is equal to their height.

D. Site Standards

1. Driveways, vehicular entrances to parking lots or structures, and curb cuts may be no wider than twenty-four (24) feet.

E. Landscape Standards

1. A front landscaped area at least ten (10) feet wide measured from the lot line toward the interior of the lot must include the following features over the span of fifty (50) linear feet:
 - (i) One (1) canopy tree
 - (ii) Two (2) understory or evergreen tree
 - (iii) Four (4) large shrubs
 - (iv) Two (2) small shrubs
1. A side or rear landscaped area at least six (6) feet wide must be provided along any side or rear lot line abutting a lot in Downtown Neighborhood (DN) district and must include the following features over the span of fifty (50) linear feet:
 - (i) Two (2) canopy trees
 - (ii) One (1) understory or evergreen tree
 - (iii) Five (5) medium shrubs and five (5) small shrubs or a fence or wall at least six (6) feet in height

F. Parking Standards

1. To reduce traffic congestion and increase convenience for customers, employees, and residents, development is encouraged to provide direct vehicular connections between abutting parking lots so that motor vehicles can move between properties without re-entering the public street.
2. To increase walkability and reduce conflicts between pedestrians and motor vehicles, development is encouraged to:
 - (a) provide only the minimum number of driveways or vehicular entrances to parking lots necessary to accommodate the number of parking spaces provided
 - (b) share driveways between abutting properties or multiple properties fronting the same street
 - (c) relocate any existing frontage area parking spaces to the side or rear of buildings.

January 2022 DRAFT

For Discussion Purposes Only

3. Establishment of a new curb cut on Route 28 or Barnstable Road must consult the Director of Public Works regarding access prior to applying for a state highway access permit from the Massachusetts Department of Transportation and work with the Town and other authorizing agencies on a transportation access plan prior to site plan approval.
4. New construction, modification of an existing principal building, and the establishment, change, or expansion of any use of real property abutting Engine House Road must provide vehicular access only from the Engine House Road frontage.
5. Parking is highly discouraged within the frontage area and should be limited to a single row of parking stalls and associated drive aisle where necessary.

DRAFT

January 2022 DRAFT

For Discussion Purposes Only

Table 9. HC Dimensional Standards

LOT		BUILDING FORM	
Lot Width	50' min	Number of Stories (max)	3 max
Lot Coverage	80% max	Building Height	40 ft max
SETBACKS – PRINCIPAL BUILDINGS			
Primary Front Setback	60' max		
Secondary Front Setback	20' min		
Side Setback	10' min		
Rear Setback	10' min		

January 2022 DRAFT

For Discussion Purposes Only

§240-24.1.13 Tables

Table 10. Dimensional Standards Summary Table

	DMS	DV	DN	DH	HH	TC	HC
A. Lot							
Lot Width	30' min	30' min	20' min	50' min	20' min	50' min	50' min
Lot Coverage	100% max	80% max	50% max	80% max	90% max	65% max	80% max
Facade Build Out	--	--	--	--	--	--	--
Primary Frontage	80% min	80% min	--	--	--	--	--
Secondary Frontage	40% min	--	--	--	--	--	--
B. Setbacks – Principal Building							
Primary Front Setback	0' min 15' max	10' min 20' max	10' min 20' max	20' min	20' min	20' min	60' max
Lots fronting Route 28	--	--	--	--	--	50' min	--
Secondary Front Setback	0' min 15' max	10' min 20' max	10' min 20' max	20' min	20' min	20' min	20' min
Side Setback	0' min	10' min	10' min	10' min	10' min	10' min	10' min
Rear Setback	0' min	20' min	20' min	10' min	10' min	10' min	10' min
C. Setbacks - Outbuilding							
Primary Front Setback	--	--	60' min	--	--	--	--
Secondary Front Setback	--	--	--	--	--	--	--
Side Setback	--	--	3' min	--	--	--	--
Rear Setback	--	--	3' min	--	--	--	--
D. Building Form							
Building Width	180' max	120' max	--	--	--	--	--
Number of Stories	--	--	--	--	--	--	--
Principal Building	3.5 or 4 max ⁶	3.5 or 4 max ⁷	3 max ⁸	6 max	2.5 max	3 max	3 max
Outbuilding	--	--	--	--	--	--	--
Ground Story Height	--	--	10' min	--	--	--	--
Commercial	14' min	14' min	--	--	--	--	--
Residential	10' min	10' min	--	--	--	--	--
Upper Story Height	10' min	10' min	10' min	--	--	--	--
Building Height	--	--	--	85' max	35' max ⁹	40' max	40' max
E. Building Features							
Ground Story Fenestration	--	--	--	--	--	--	--
Primary Frontage	60% min	15% min	--	--	--	--	--
Secondary Frontage	15% min	15% min	--	--	--	--	--
Upper Story Fenestration	15% min	15% min	--	--	--	--	--
Blank Wall	20' max	20' max	--	--	--	--	--
Commercial Space Depth	20' min	20' min	--	--	--	--	--

⁶ See 240-24.1.6.C.6 (4th Story Step-back)

⁷ See 240-24.1.6.C.6 (4th Story Step-back)

⁸ See 240-24.1.8.C.2(a)

⁹ See 240-24.1.10.C.2(a)

January 2022 DRAFT
For Discussion Purposes Only

Table 11. Frontage Types

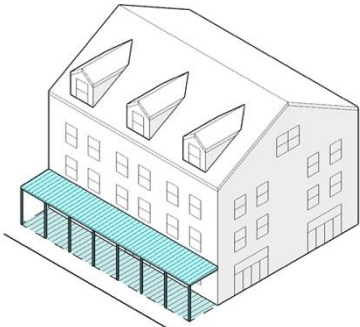
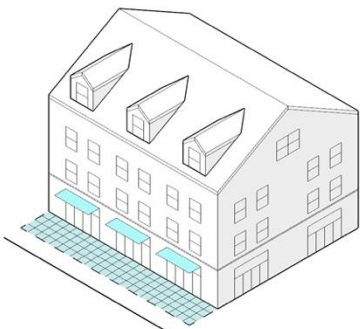
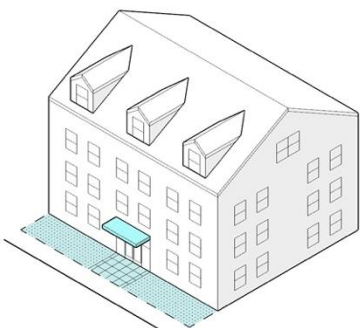
P – Permitted N – Not Permitted	DMS	DV	DN	DH	HH	TC	HC
<p>Gallery</p>  <p>A frontage type consisting of a storefront(s) and an attached colonnade with a roof, open pergola, or balcony overhanging a paved sidewalk. A gallery may wrap around the corner of a building to create a veranda-like gallery.</p>	P	P	N	P	P	P	P
<p>Storefront</p>  <p>A frontage type consisting of an assembly of commercial entry doors and display windows providing access and light to a commercial space and a place to display goods, services, and signs.</p>	P	P	N	P	P	P	P
<p>Common Lobby</p>  <p>A frontage type consisting of an assembly of entry doors and windows providing access and light to the lobby of a building. A common lobby may be combined with an entry plaza or front garden frontage type.</p>	P	P	N	P	P	P	P

January 2022 DRAFT
For Discussion Purposes Only

Table 11. Frontage Types

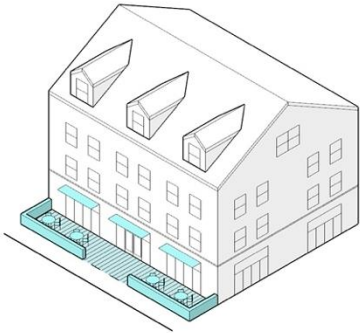
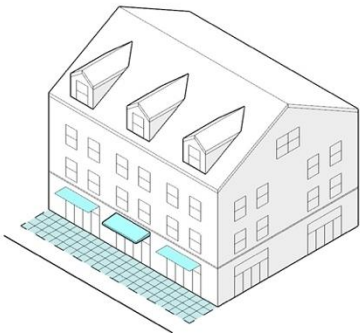
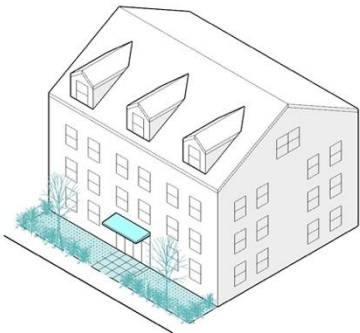
P – Permitted N – Not Permitted	DMS	DV	DN	DH	HH	TC	HC
<p>Dining Patio</p>  <p>A frontage type consisting of a storefront(s) and outdoor café seating in the frontage area.</p>	P	P	N	P	P	P	P
<p>Entry Plaza</p>  <p>A frontage type consisting of a storefront(s) and a highly paved frontage area. An entry plaza may be combined with a common lobby frontage type.</p>	P	P	N	P	P	P	P
<p>Front Garden</p>  <p>A frontage type consisting of a highly landscaped frontage area. A front garden may be combined with a common lobby, dooryard or stoop, or porch frontage type.</p>	N	P	P	P	N	N	N

January 2022 DRAFT
For Discussion Purposes Only

Table 11. Frontage Types

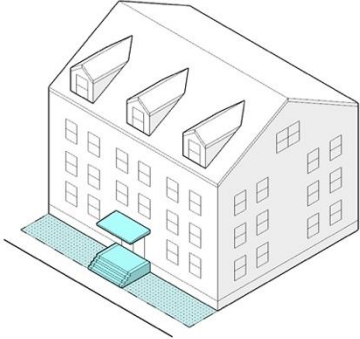
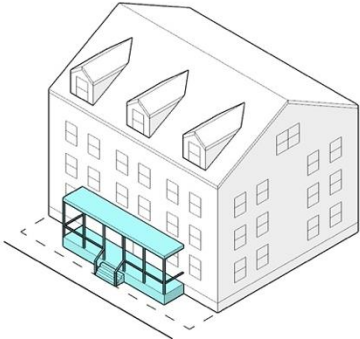
P – Permitted N – Not Permitted	DMS	DV	DN	DH	HH	TC	HC
<p>Dooryard or Stoop</p>  <p>A frontage type consisting of a zero-step entrance or a set of stairs with a landing that provides access to the entrance of a building. A dooryard or stoop may be combined with a front garden frontage type.</p>	N	P	P	N	N	N	N
<p>Porch</p>  <p>A frontage type consisting of a raised platform with a roof supported by columns, piers, or posts; an area for seating; and an optional set of stairs with a landing that provides access to the entrance of a building. A porch may be combined with a front garden frontage type</p>	N	P	P	N	N	N	N

January 2022 DRAFT
For Discussion Purposes Only

Table 12. Building Components

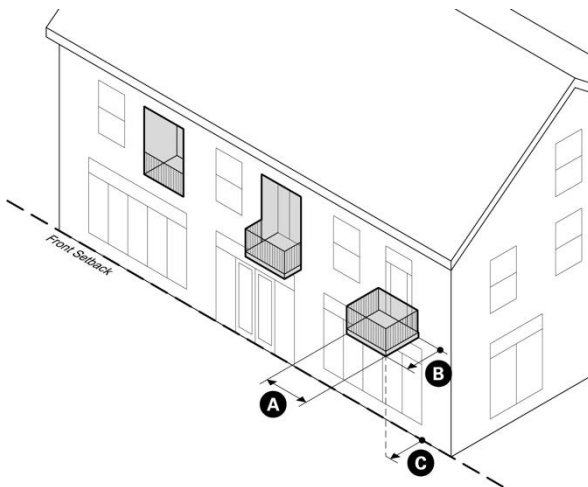
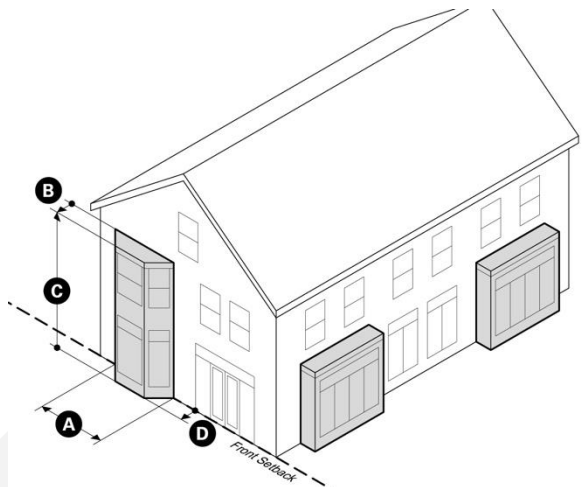
A. Balcony			B. Bay or Oriel Window		
					
A	Width (min)	5 ft	A	Single Bay Width (max)	16 ft
B	Depth (min)	4 ft		Cumulative Bay Width (max)	50% of the width of the exterior wall from which the bays project
	Area (min)	20 sf	B	Projection (max)	3 ft
C	Front Setback Encroachment (max)	5 ft	C	Stories (max)	Same as the principal building
			D	Front Setback Encroachment (max)	3 ft
<p>Design Standards:</p> <p>Balconies may attach to any exterior wall of a principal building.</p> <p>Balconies may be recessed, projecting, a combination of the two, or terraced as part of the roof of a permitted building component.</p>			<p>Design Standards:</p> <p>Bays may attach to any exterior wall of a principal building.</p> <p>A bay window may have a flat roof.</p>		

January 2022 DRAFT

For Discussion Purposes Only

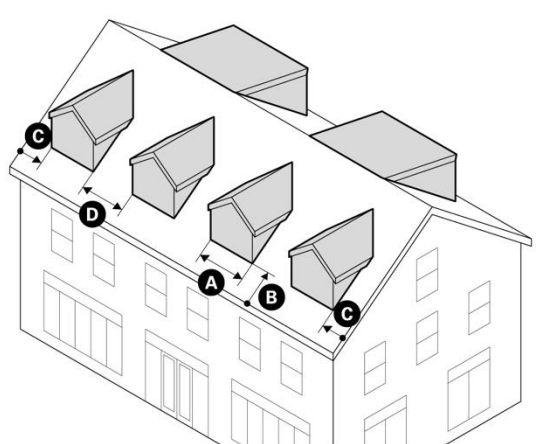
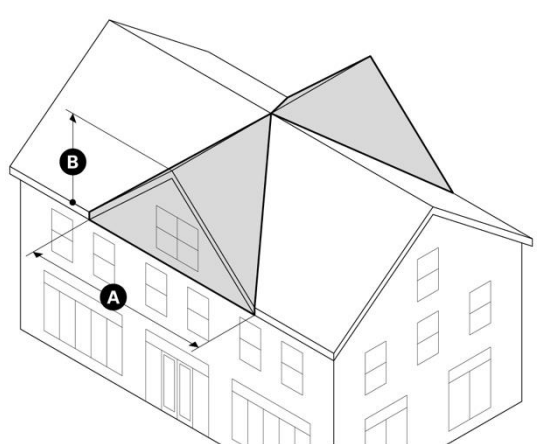
C. Dormer			D. Cross Gable		
					
A	Cumulative Width of all Dormers (max)	50% of the roof eave	A	Width (max)	50% of the roof eave below
B	Exterior Wall Setback (min)	--	B	Height (min)	Equal to the height of the roof of the attached primary massing
	Roof with Eave	0 ft		Design Standards:	
	Roof without Eave	1 ft			
C	Setback from Gable (min)	3 ft		The roof ridge of a cross gable must be perpendicular to the main roof ridge of the principal building.	
D	Separation from another Dormer (min)	50% of dormer width		The rakes and ridge of the roof of the cross gable must be structurally integrated into the eave and ridge of roof of the attached primary massing.	
	Design Standards: The face wall of a dormer window may not project beyond the exterior wall of the building and may not interrupt the eave of the roof.				

January 2022 DRAFT

For Discussion Purposes Only

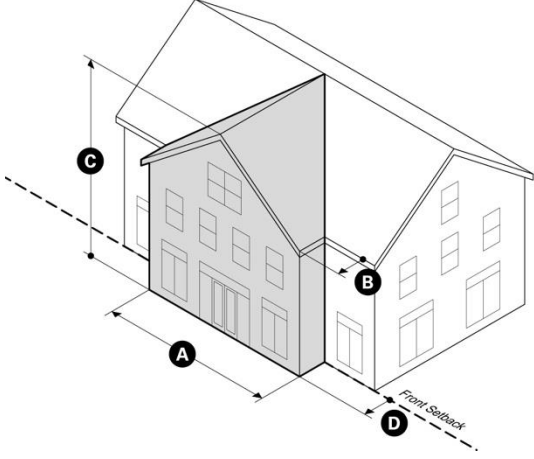
E. Projecting Gable		
		
A	Width (max)	Equal to the shortest side of the attached primary massing
B	Projection (max)	6 ft
C	Height (min)	Height of Building in Stories
D	Front Setback Encroachment (max)	6 ft
<p>Design Standards:</p> <p>A projecting gable may attach only the façade of a principal building.</p> <p>The roof ridge of a projecting gable must be perpendicular to the main roof ridge of the principal building.</p>		